

# Ornament Making.

## Detroit Area Woodturners

By Greg Smith

These plans are not original and more detail instructions may be found as written by **Eugen Schlaak**, Woodturner. Niagara Falls Ontario Canada. He has written detailed instructions on both the angle and 2 piece bird house.

I use a simple shellac based finish like the 321, or Mylands friction polish, or Shellawax. Other finishes may also be used depending on your preference.

Screw eyes can be found at [bennyswoodworks.com](http://bennyswoodworks.com) cat no. SE-B172, they are the 1/2 inch long ones and cost \$02 each in lots of 1,000

drill for the screw eye with a No 58 numbered drill. do not force the screw eye in or you will break it off.

### Angel Ornament

Wood 2x2 by 4 inch block.

The distance from the bottom to the tip of the arms should be a little longer then the base diameter. In this case about 2.5 inches. The diameter of the waist is 1/2 to 5/8 dia.

The head should be roughed to about 7/8 and will finish at 3/4 or less. the goal should be to keep the arms as narrow as possible and the angle even on both sides.

the Halo should be 3/4 Of the base diameter in this case 1 1/2 in. and about 1/8 inch thick.

The screw eye or hook should be centered

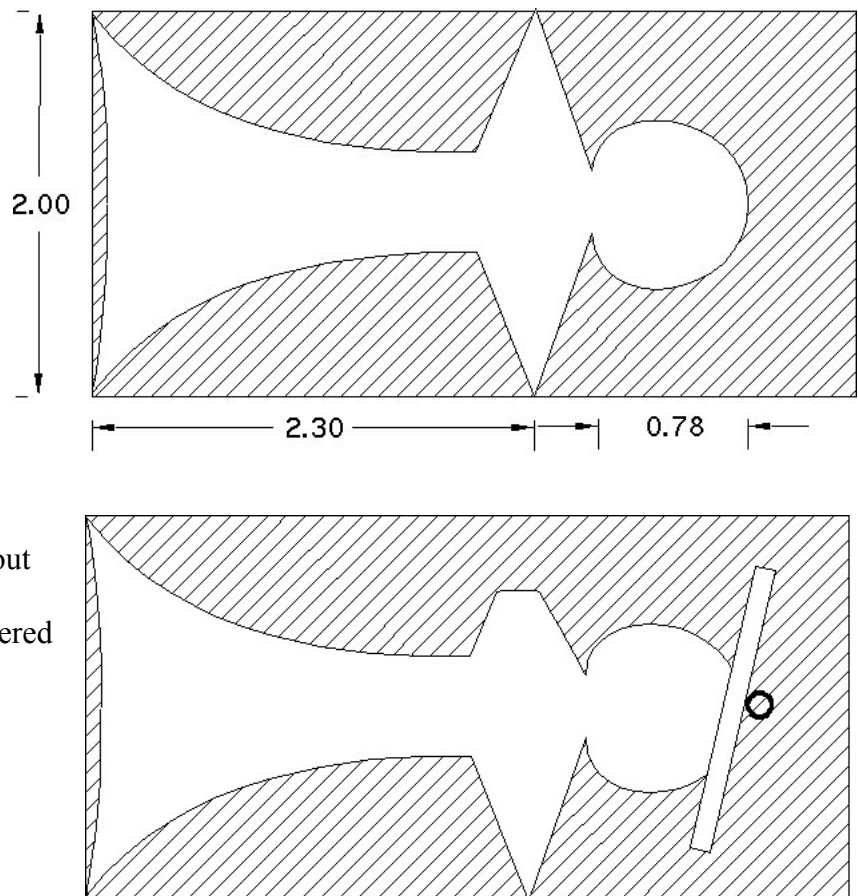

## Two Piece birdhouse Ornament (roof and body)

Prepare you blocks and cut all to the same length, mark the centers of both blanks and draw a line down the center of one side on the base. Pre-drill all parts. Drill the top drill a 1 1/4 forestner bid about 1/2 in deep, a second drill may be used to remove more wood.

The bottom blank should be marked on one side on the centerline and the 1/2 in opening hole drilled, then the 1/8 in roost drill, by doing it in this order when you drill the 1 inch hole it will provide a clean cut where it intersects the side opening hole.

The spigot jaws on a Tallon chuck will just fit in the 1 inch hole of the base. If you do not have this chuck you will need to adapt the dimensions to fit your chuck

## Medium One Piece Birdhouse Ornament

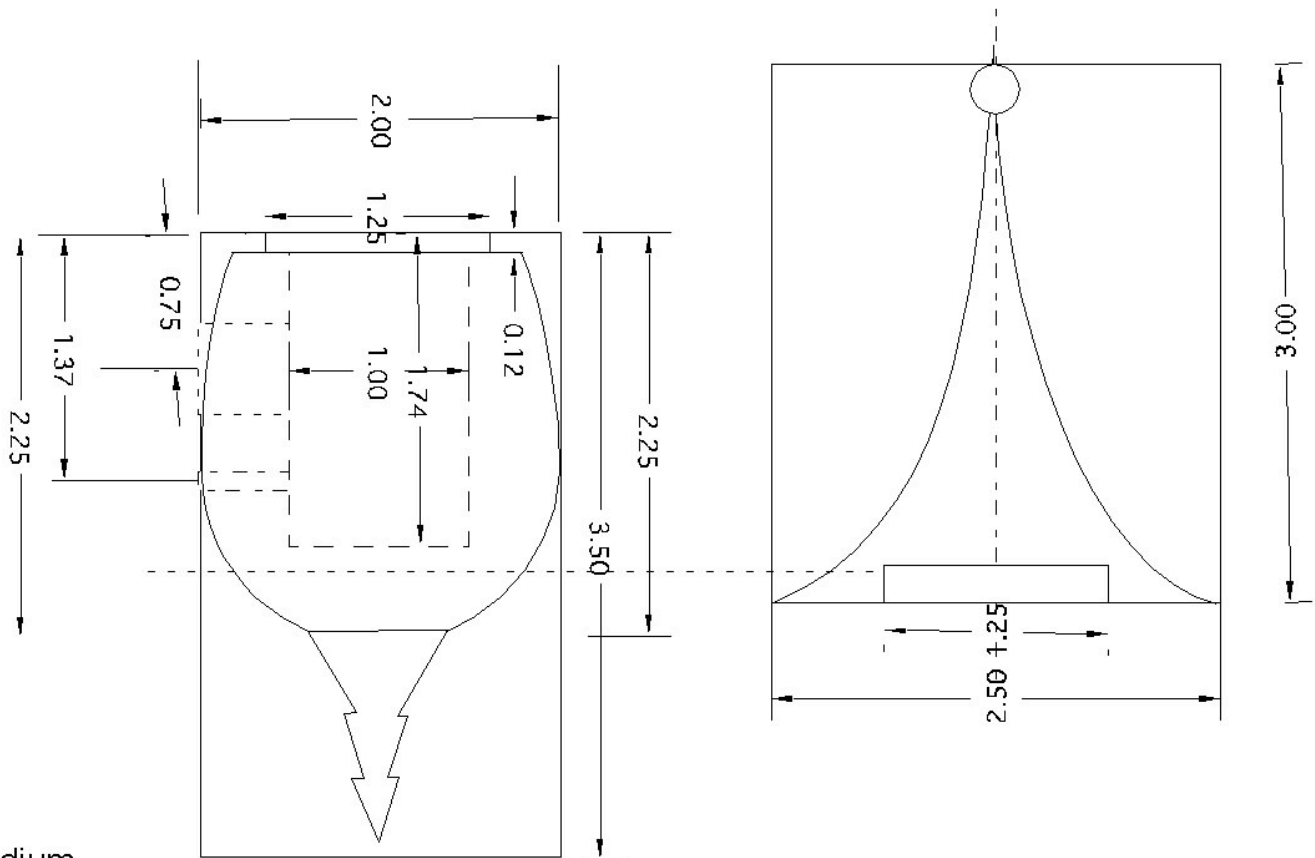

Medium  
One Piece  
Bird House Ornament  
Blank 2 x 3 1/2 for Body  
Blank 2 1/2 x 3 for Roof.

Eugen Schlaak Style  
by Greg Smith  
Oct 2007